

# Mosaico FX100FC

Image projector with dual animation wheel and 1 gobo/color slot, 100W RGBW LED source



**Mosaico FX100FC** is an 100W RGBW Full Color LED IP66 image projector, engineered to be the modular platform to add building blocks to design your creative architectural lighting landscape.

**Mosaico FX100FC** is supplied with two controllable effect wheels on board made in structured glass material to animate your projection, with linear motion control for creating reflected water, blowing fire or northern lights effects. The kit contains also one indeaxable gobo holder and a colour holder both with magnetic attachment.

**Mosaico FX100FC** is compatible with a wide range of high definition optics, each optimized for the required application (animation or image projection): 15°, 30°, 50° and 70°.

This unit can be controlled via DMX, both wired and wireless and also easily operated locally through the simplified stand alone operations.

Please note that **Mosaico FX100FC** do not ship with a lens or other images or colors. Choose from the available lenses when ordering to meet your design requirements.

## MAIN FEATURES

- 100W RGBW LED Source Image and Effect light projector
- 15°, 30°, 50° and 70° available optics (not included), Image or Effects optimized
- DMX, CRMX Wireless and local stand alone control

## VERSIONS

Code	Housing
MOSAICOFX100FCGY	Gray
MOSAICOFX100FCBK	Black

## TECHNICAL SPECIFICATION

### LIGHT SOURCE

- Source:100 W RGBW / FC LED
- Luminous flux:(15°) 1'212 lm; (30° - WT) 1'214 lm; (30° - GB) 1'132 lm; (50° - WT) 1'340 lm; (50° GB) 896 lm; (70°) 960 lm @full
- Lux:(15°) 633 lx; (30° - WT) 392 lx; (30° - GB)0 165 lx; (50° - WT) 179 lx; (50° GB) 74 lx; (70°) 92 lx @5 m full
- Source life expectancy: > 30.000 hrs (L70B10 @Ta 25° C / 77° F)

### OPTICS

- Optics:interchangeable - see available accessories
- Focus: manual
- COLOUR SYSTEM
- Colour wheel: included 1 color holder accessory for 1 color (color not included)
- Colour wheel: optional color wheel with 5 colors included on board (see available accessories) - included colors Light Orange, Light Green, Yellow, Aquamarine, Pink

### DYNAMIC EFFECTS

- Control Resolution: 16-bit dimmer, colours
- Animation wheel: included 2 interchangeable wheels with indexing and CW and CCW rotation with variable speed (see available accessories)
- Rotating gobos: included 1 gobo holder with manual adjustable index position system for 1 gobo (gobo not included - see available accessories)
- Gobo size (BW):outer: 26,9 mm - image: 22 mm
- Gobo size (Color):outer: 26,9 mm - image: 20,5 mm
- Fixed gobos: optional gobo wheel for 5 gobos + open (gobos not included - see available accessories)
- Static mode: selection of static dimmer, colors and effects rotation mode

### BODY

- Body: weatherproof IP66 construction
- Body colour: RAL 9006 or RAL 9004
- Other:Inspectable cover window for effects and gobo replacement and maintenance

### CONTROL

- Protocols: DMX512, RDM, CRMX + WDMX, 3 push encoder
- Stand Alone:3 push encoder
- DMX channels:13 channel
- Wireless Control: included, LumenRadio Timo Fx DMX/RDM compatible with both CRMX (Lumen Radio) and W-DMX (Wireless DMX)
- RDM: RDM for remote monitoring and settings
- Display: user interface through DATAMASTER external coder (not included)
- Firmware upgrade: yes, via USB - DMX interface (UPBOX2) not included
- Master/Slave: for synchronised operation of more units linked in a chain

### ELECTRONICS

- Dimmer: linear 0 ~ 100%, electronic and manual knob dimmer
- Dimmer curves: selectable dimming modes available
- Strobe / shutter:1-30 Hz, electronic
- Operating temperature: -20° C / +45° C (-4° F / +113° F)
- LED Control: flicker free frequency with adjustable PWM
- Selectable PWM: 600 ~ 25.000 Hz

### ELECTRICAL

- Mains power supply: 100-240V - 50/60Hz
- Max power consumption:120 W
- Output (at 230V):25
- Power factor:>0.95

### PHYSICAL

- IP rating:66 for outdoor installations
- Cooling: active, silent operation
- Suspension and fixing: bracket for hanging and positioning
- Adaptors: XLR and BARE END 16A adaptors included
- Signal connection:35 cm moulded IP signal IN/OUT connectors
- Power connection:35 cm moulded IP power IN/OUT connectors
- Dimensions (WxHxD):224x261x221 mm
- Weight:5,8 kg

### CERTIFICATIONS / APPROVALS

- Certifications / Approvals: CE, UKCA, RCM

## ACCESSORIES & RELATED PRODUCTS

- MFX100BAG1U Pelican case for 1 pc of MOSAICOFX100
- MFX100WBRAKGY/BK Wall bracket for MOSAICOFX100, grey/black housing
- MFX100FBRAKGY/BK Floor bracket for MOSAICOFX100, grey/black housing
- MOSUNIBRACKJR Bracket for MOSAICOFX100 for wall mounting and suspension on poles
- MFX100LWGN 15° lens for MOSAICOFX100 series, narrow for water effect and gobo
- MFX100LWGVW 70° lens for MOSAICOFX100 series, very wide for water effect and gobo
- MFX100LWTM 30° lens for MOSAICOFX100 series, medium for water effect
- MFX100LWTV 50° lens for MOSAICOFX100 series, wide for water effect
- MFX100LGBM 30° lens for MOSAICOFX100 series, medium for gobo
- MFX100LGBW 50° lens for MOSAICOFX100 series, wide for gobo
- GBVFX100120F06 Cyan filter with white stripes for MOSAICOFX100
- GBVFX100220F03 Red filter with white stripes for MOSAICOFX100
- GBVFX100320F04 Green filter with white stripes for MOSAICOFX100
- MFX100RAINW Structured glass RAIN effect animation wheel
- MFX100HAMMERHEADW Structured glass HAMMERHEAD effect animation wheel
- MFX100D35C Color for MFX100CH for MOSAICOFX100, 34,5 mm d. (RED, GREEN, BLUE, CYAN, MAGENTA, YELLOW, PINK MARINE, LIGHT ORANGE, LIGHT GREEN)
- MFX100WE1 Water effect wheel for MOSAICOFX100 series, short axis 1
- MFX100WE2 Water effect wheel for MOSAICOFX100 series, long axis 2
- MFX100GW Gobo wheel for MOSAICOFX100 series (gobos not included)
- MFX100CW Color wheel for MOSAICOFX100 series

- MFX100GH Gobo holder for MOSAICOFX100 series (gobo not included) with manual indexing
- MFX100CH Color holder for MOSAICOFX100 series (color not included)
- MFX100SNOOT BK/GY Snoot for MOSAICOFX100 series grey/black colour
- MFX100SNOOTPROT BK/GY Anti tampering full snoot with front glass grey/black colour
- AWEXAC12ADP Power adapter from AWEXAC1 cable series to AWEXAC2 cable series
- AWEXDC1221ADP Signal adapter kit from AWEXDC1 series to AWEXDC2 series and vice versa
- AWEXAC1L03/05/10/20 IP67 power extension cable for outdoor architectural projectors, L.03/05/10/20 m
- AWEXDC1L03/05/10/20 IP67 DMX extension cable for outdoor architectural projectors, L.03/05/10/20 m
- UPBOX1UP5 Firmware uploader kit, USB IN, 5pin XLR DMX OUT, USB OUT
- C6002B Slim aluminum clamp, 200kg loading, 48-51mm tubes, M10 bolt, Black
- RSR1235B Steel security cable for hanging bodies, inox steel shackle, L=120 cm, black
- LRLUNA Single Universe DMX transceiver with Bluetooth
- LRAURORA Single Universe DMX/RDM transceiver with WiFi and Bluetooth
- MFX100AW Animation wheel for MOSAICOFX100 series

## PRESET FULL ON

Beam angle 50%: 15° LWGN

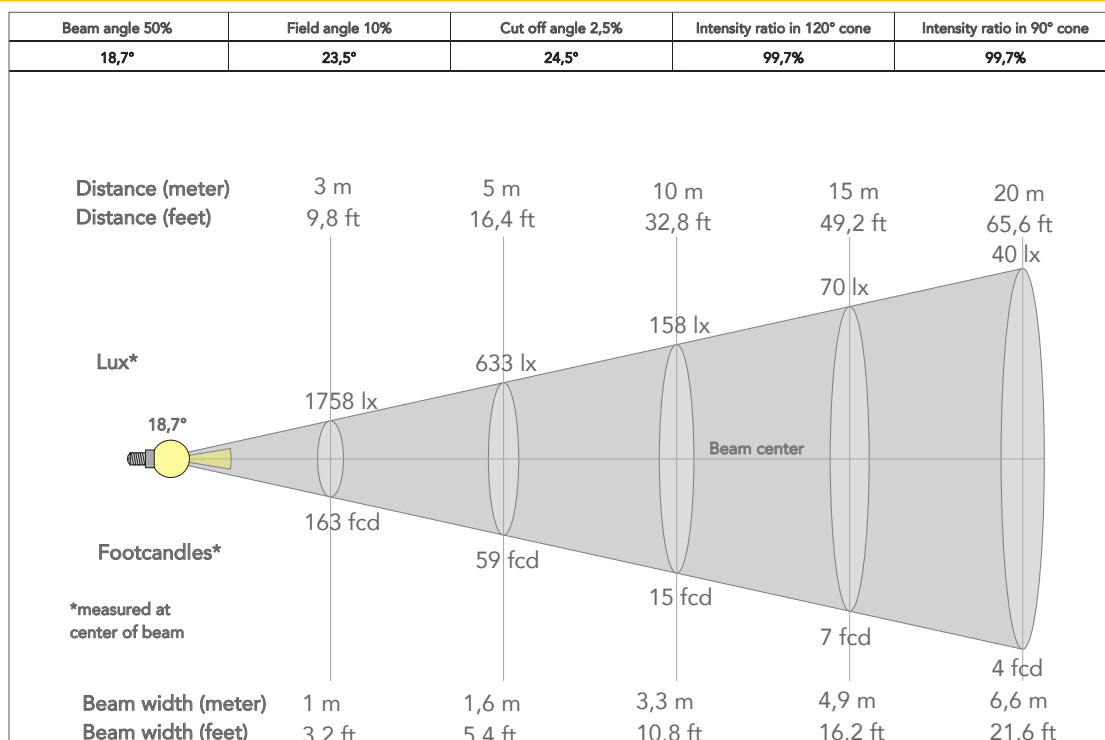

## TECHICAL DRAWINGS

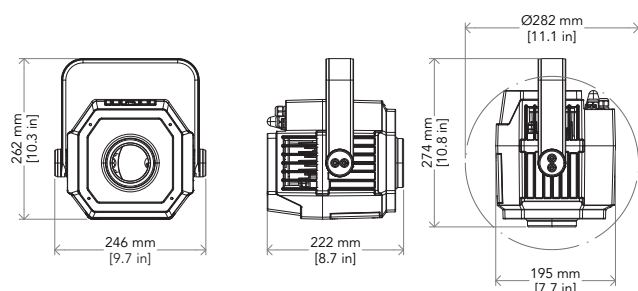

## CERTIFICATIONS / APPROVALS

